



Miscellaneous Equipment & Parts Index Page

	Page
• Guiberson 'H' & 'HD' Oil Savers	1 - 2
• Guiberson Rope Sockets & Sinker Bars	3
* Web Wilson 8-Ton Tong Block	4
• Varco Square Kelly Roller Assemblies & Rollers	5
• Varco Hex Kelly Roller Assemblies & Rollers.	6
• Varco Kelly Bushing Parts	7
• Varco HDP, HDS, 4KRP, 4KRS Pipe Wiper Assembly.	8
• Varco MD, 4KRVS, 4KBM Pipe Wiper Assembly.	9
• Pipe Wiper Retainer Plates & Bolts.	10

Type 'H' & 'HD' Oil Savers

Oil Savers strip the wireline clean of fluids: cuts cost by saving valuable oil; promotes safety by minimizing danger of explosion or fire at the well site. The Oil Saver uses a special oil, gas and abrasion resistant, one piece rubber for efficient, low cost oil removal.

The 'H' savers are operated by the field proved piston principle; there are no troublesome bladders or complicated mechanisms. All provide an extra large rubber and generous bushings for smooth, constant seal and maximum utilization of each rubber.

Series 'H' savers are available with 2-3/8" EUE or 2-7/8" EUE, 3-1/2" OD. LP. 8V field connections, and all Savers may be adapted from one connection to another simply by changing the base.

The 'H' and the 'HD' Oil Savers are both 1500 PSI working pressure. Both utilizing brass bushing with rubbers. The 'HD' is also fitted with a 1" drain connection between the rubbers.

Cat. #	Ref. #	Description	Wt.
Single Oil Saver Assemblies			
74-5007-1	41427	2-3/8" 'H' Oil Saver w/Pine Pump, Hose & Gauges	82.0
74-5007-2	41427	2-3/8" 'H' Oil Saver w/Star Pump, Hose & Gauges	82.0
74-5007-3	40643	2-3/8" 'H' Oil Saver Only	53.0
74-5008-1	41428	2-7/8" 'H' Oil Saver w/Pine Pump, Hose & Gauges	82.0
74-5008-2	41428	2-7/8" 'H' Oil Saver w/Star Pump, Hose & Gauges	82.0
74-5008-3	41064	2-7/8" 'H' Oil Saver Only	53.0
74-5013-1	41429	3-1/2" 'H' Oil Saver w/Pine Pump, Hose & Gauges	82.0
74-5013-2	41429	3-1/2" 'H' Oil Saver w/Star Pump, Hose & Gauges	82.0
74-5013-3	41065	3-1/2" 'H' Oil Saver Only	53.0
Tandem Oil Saver Assemblies			
74-6007-1	54716	2-3/8" 'HD' Oil Saver w/Pine Pump, Hose & Gauges	82.0
74-6007-2	54716	2-3/8" 'HD' Oil Saver w/Star Pump, Hose & Gauges	82.0
74-6007-3	54724	2-3/8" 'HD' Oil Saver Only	53.0
74-6008-1	44371	2-7/8" 'HD' Oil Saver w/Pine Pump, Hose & Gauges	82.0
74-6008-2	44371	2-7/8" 'HD' Oil Saver w/Star Pump, Hose & Gauges	82.0
74-6008-3	44247	2-7/8" 'HD' Oil Saver Only	53.0
74-6013-1	54721	3-1/2" 'HD' Oil Saver w/Pine Pump, Hose & Gauges	82.0
74-6013-2	54721	3-1/2" 'HD' Oil Saver w/Star Pump, Hose & Gauges	82.0
74-6013-3	54729	3-1/2" 'HD' Oil Saver Only	53.0
Oil Saver Pump Assemblies			
74-7000	68883	Oil Saver Pump, Hose & Gauge (Pine Type)	35.0
74-7010	68883	Oil Saver Pump, Hose & Gauge (Star Type)	35.0



Replacement "H" & "HD" Oil Savers & Parts

Rig Tool Part #	Description	Qty. Req.	Parts Type & Number	
			"H"	"HD"
	Base	1	-	-
74-5007	2-3/8" 8RD EUE Pin	-	40624	40624
74-5008	2-7/8" 8RD EUE Pin	-	40623	40623
74-5013	3" L.P. 8V Pin	-	40726	40726
74-9900	Body, Type "H"	1	39670	-
74-9905	Body, Type "HD"	1	-	40274
	*Bushings with clips	2 sets	-	-
74-8500	Blank to 5/16"	-	42878	42878
74-8510	3-8" to 5/8"	-	46176	46176
74-8520	3/4" to 1"	-	41571	41571
74-9910	Gate	1	39672	39672
74-9915	Bushing Spacer	1	-	40275
74-9920	Housing	1	40617	40617
74-9925	Housing Bushing	1	31742	31742
74-9930	Housing Nipple	1	59064	59064
74-9935	Housing Nose	1	40629	40629
74-9940	Housing Plug	1	13550	13550
74-9945	Housing Street Elbow	1	40639	40639
	**Rubber	1	-	-
75-7400	Blank to 5/16"	-	42883	42883
75-7405	3/8" to 5/8"	-	39675	39675
75-7410	3/4"	-	41572	41572
74-9500	Spring	1	39676	39676
74-9950	Yoke	1	27484	27484
74-9955	Yoke Retainer Pin	1	54509	54509
74-9960	Hose Ass'y - 50' MEA	1	40631	40631
74-9965	Coupler	(2)	40630	40630
74-8400	Repair Kit	1	53728	53728
74-8401	Base O-Ring	(1)	16589	16589
74-8402	Body O-Ring	(1)	25790	25790
74-8403	Housing O-Ring	(1)	17468	17468
74-8404	Ram O-Ring	(1)	88614	88614
74-8405	Housing Wiper Ring	(1)	39679	39679

* (2 sets) for "H" (4 sets) for "HD"

** (1) for "H" (2) for "HD"

() Parenthesis on number required indicate parts of assembly listed above.

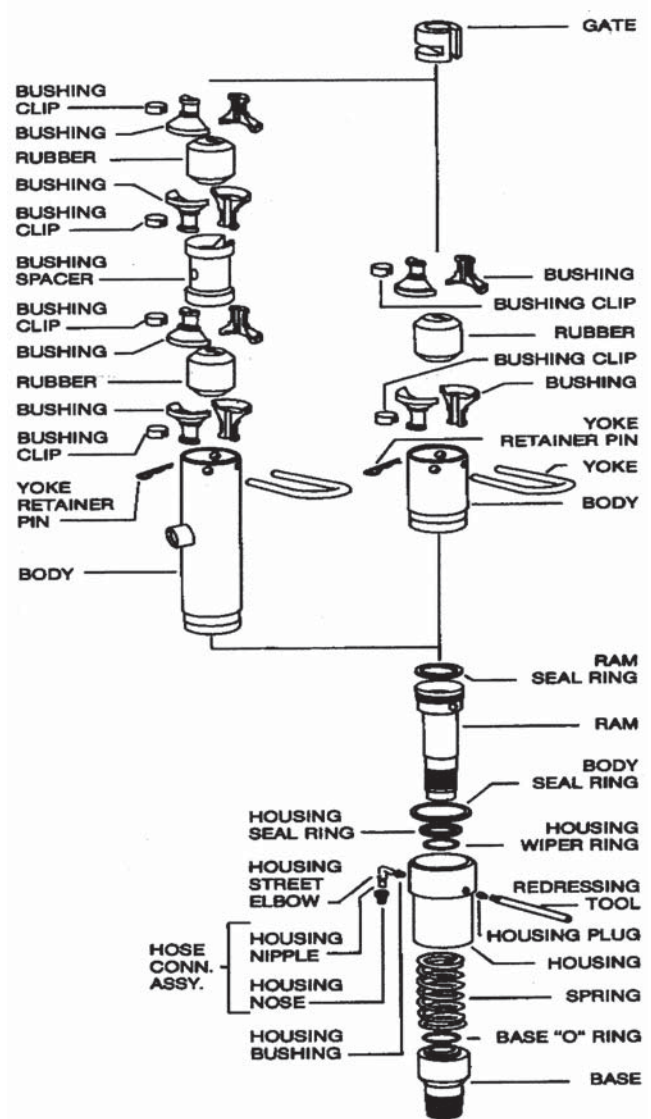



Rope Sockets & Sinker Bars

Rope Sockets provide a strong simple connection between the end of the wireline and the sinker bar. The top half of these sockets is provided with fish neck grooves. Top halves of plain and swivel sockets are interchangeable.

Sinker Bars are available in 1-1/2" and 1-3/4" Diameters and are stocked in 5 and 10 foot lengths. Made of High Strength cold finished alloy material.

Cat. #	Ref. #	Description	Wt. Ea.	Qty. Req.	Box
Rope Socket Assemblies					
74-2030	41876	5/8" S. R. Box 1-1/2" (1.900") to 3-1/2" w/Swivel for 9/16" Wireline	6.0	1	A/R
74-2040	41877	5/8" S. R. Box 1-1/2" (1.900") to 3-1/2" w/Swivel for 5/8" Wireline	6.0	1	A/R
74-2050	20511	3/4" S. R. Box 2-3/8" to 3-1/2" w/Swivel for 9/16" Wireline	7.0	1	A/R
74-2060	20512	3/4" S. R. Box 2-3/8" to 3-1/2" w/Swivel for 5/8" Wireline	7.0	1	A/R
74-2070	20518	7/8" S. R. Box 2-3/8" to 3-1/2" w/Swivel for 9/16" Wireline	7.0	1	A/R
74-2080	20519	7/8" S. R. Box 2-3/8" to 3-1/2" w/Swivel for 5/8" Wireline	7.0	1	A/R
Rope Socket Parts					
74-2035	41870	Rope Socket Body 1-1/2" (1.900) to 3-1/2" for 9/16" Wireline	3.0	1	A/R
74-2045	41871	Rope Socket Body 1-1/2" (1.900) to 3-1/2" for 5/8" Wireline	3.0	1	A/R
74-2055	13728	Rope Socket Body 2-3/8" to 3-1/2" for 9/16" Wireline	3.0	1	A/R
74-2065	13729	Rope Socket Body 2-3/8" to 3-1/2" for 5/8" Wireline	3.0	1	A/R
74-2075	41893	5/8" S. R. Box 1-1/2" (1.900") to 3-1/2" Swivel Sub for 1/4" to 5/8" Wireline	3.0	1	A/R
74-2085	20599	3/4" S. R. Box Swivel Sub 2-3/8" to 3-1/2" for 1/4" to 3/4" Wireline	3.0	1	A/R
74-2095	20600	7/8" S. R. Box Swivel Sub 2-3/8" to 3-1/2" for 1/4" to 3/4" Wireline	4.0	1	A/R
Sinker Bars Assemblies					
74-3030	11714	3/4" Sucker Rod Thread 1-1/2" (1.900") to 3-1/2", 1-1/2" O.D. x 5'	30.0	1	A/R
74-3040	20543	3/4" Sucker Rod Thread 1-1/2" (1.900") to 3-1/2", 1-1/2" O.D. x 10'	60.0	1	A/R
74-3050	20549	3/4" Sucker Rod Thread 2-3/8" to 3-1/2", 1-3/4" O.D. x 10'	82.5	1	A/R



8-Ton Manual Tong Block

Cat. #	Ref. #	Description	Wt. Ea.	Qty. Req.	Box
8-Ton Tong Block Assembly					
40-1000	8522-1000	Tong Block (Less Adapter)	13.0	1	A/R
40-1010	8522-1002	Tong Block Complete for Web Wilson Tongs	17.0	1	A/R
40-1020	8522-1003	Tong Block Complete for BJ Tongs (except SDD & DB)	16.0	1	A/R
40-1030	8522-1004	Tong Block Complete for BJ Tongs, SDD & DB	17.0	1	A/R
Replacement Parts					
40-1050	9-B-18	Tong Adapter	3.0	1	A/R
40-1055	9-B-17	BJ Tong Adapter Except DB & SDD	2.0	1	A/R
40-1060	9-B-23	BJ Tong Adapter for DB & SDD	3.0	1	A/R
40-1065	9-B-29	Web Wilson Adapter Pin	1.0	1	A/R
40-1070	9-B-22	BJ Adapter Pin	1.0	1	A/R
40-1075	8522-1001	Sheave Assembly	5.0	1	A/R
40-1080	9-C-15	Housing	8.0	1	A/R
40-1085	9-B-21	Sheave Pin	1.0	1	A/R

Square Roller Assemblies & Rollers

Kelly Size	HDP & HDPS* Part #	Wt. Lbs.	MDP & MDS Part #	Wt. Lbs.	4KRVS* Part #	Wt. Lbs.	4KRBM Part #	Wt. Lbs.
Square Roller Assemblies Complete (Set of 4)								
2-1/2" SQ. Roller Complete			35-2050 70474-4	192	35-2090 1445	246	35-2140 2949	117
3" SQ. Rollers Complete	35-2000 3660	590	35-2060 70474-5	176	35-2100 1446	228	35-2150 2943	103
3-1/2" SQ. Rollers Complete	35-2010 3661	562	35-2070 70474-6	160	35-2110 1447	204	35-2160 2944	89
4-1/4" SQ. Rollers Complete	35-2020 3662	512	35-2080 70474-7	132	35-2120 1448	175	35-2170 2945	69
5-1/4" SQ. Rollers Complete	35-2030 3665	438			35-2130 1449	131		
6" SQ. Rollers Complete	30-2040 3666	374						

Kelly Size	HDP & HDPS* Part #	Wt. Lbs.	MDP & MDS Part #	Wt. Lbs.	4KRVS* Part #	Wt. Lbs.	4KRBM Part #	Wt. Lbs.
Square Kelly Rollers Only (Set of 4)								
2-1/2" SQ. Rollers Only			35-2051 70593-4	129	35-2091 1430-4	186	35-2141 2933-4	84
3" SQ. Rollers Only	35-2001 1331-4	396	35-2061 70593-5	113	35-2101 1431-4	168	35-2151 2930-4	70
3-1/2" SQ. Rollers Only	35-2011 1332-4	368	35-2071 70593-6	97	35-2111 1432-4	144	35-2161 2931-4	56
4-1/4" SQ. Rollers Only	35-2021 1333-4	318	35-2081 70593-7	69	35-2121 1433-4	116	35-2171 2932-4	34
5-1/4" SQ. Rollers Only	35-2031 1334-4	244			35-2131 1434-4	72		
6" SQ. Rollers Only	35-2041 1335-4	180						

* Sleeve bearings are standard, roller bearings are optional. Add R at end of part number.

Hex Roller Assemblies & Rollers

Kelly Size	HDP & HDPS* Part #	Wt. Lbs.	MDP & MDS Part #	Wt. Lbs.	4KRVS* Part #	Wt. Lbs	4KRBM Part #	Wt. Lbs.
Hex Roller Assemblies Complete (Set of 4)								
3" Hex Rollers Complete	35-2200 3667	612	35-2260 70474-1	162	35-2290 1450	236	35-2320 5210	103
3-1/2" Hex Rollers Complete	35-2210 3668	584	35-2270 70474-2	146	35-2300 1451	216	35-2330 5211	95
4-1/4" Hex Rollers Complete	35-2220 3669	532	35-2280 70474-3	126	35-2310 1452	191	35-2340 2948	77
5" Sp. Hex Rollers Complete	35-2230 3671	486						
5-1/4" Hex Rollers Complete	35-2240 3672	476						
6" Hex. Rollers Complete	35-2250 3673	414						

Kelly Size	HDP & HDPS* Part #	Wt. Lbs.	MDP & MDS Part #	Wt. Lbs.	4KRVS* Part #	Wt. Lbs	4KRBM Part #	Wt. Lbs.
Hex Kelly Rollers Only (Set of 4)								
3" Hex Rollers Only	35-2201 1338-39	407	35-2261 70593-1	99	35-2291 1437-38	174	35-2321 5221-22	76
3-1/2" Hex Rollers Only	35-2211 1340-41	390	35-2271 70593-2	88	35-2301 1439-40	160	35-2331 5223-24	62
4-1/4" Hex Rollers Only	35-2221 1342-43	338	35-2281 70593-3	63	35-2311 1441-42	134	35-2341 2939-40	42
5" Sp. Hex Rollers Only	35-2231 1387-88	292						
5-1/4" Hex Rollers Only	35-2241 1344-45	292						
6" Hex Rollers Only	35-2251 1346-47	220						

* Sleeve bearings are standard, roller bearing are optional. Add R at end of part number.

Roller Kelly Bushing Parts

Description	HDP & HDS		MDP & MDS		4KRVS		4KRBM		4KRP/KRS	
	Parts #	Qty. Wt.	Part #	Qty. Wt.	Part #	Qty. Wt.	Part #	Qty. Wt.	Part #	Qty. Wt.
Roller Pin	35-2400 3609	4 33.0	35-2424 70470	4 8.5	35-2450 1411	4 8.0	35-2460 2910	4 5.0	35-2468 1311	4 26.0
Sleeve Bearing	35-2402 1326	4 2.0	35-2426 70465	4 1.0	35-2452 1422	4 8.0	35-2462 5218	4 0.25	35-2470 1326	4 2.0
Roller Bearing	35-2404 1312	4 7.0			35-2454 1412	4 3.0			35-2472 1312	4 7.0
Thrust Washer	35-2406 3618	8 5.0	35-2430 70468	8 1.75	35-2456 1413	8 3.0	35-2464 2912	8 0.50	35-2474 1313	8 3.0
Nut	97-40-4800-45 1208	4 1.75	97-40-4800-45 1208	4 1.75	97-40-4800-45 1208	4 1.75	97-40-4800-45 1208	4 1.75	97-40-4800-45 1208	4 1.75
Lockwasher	35-2410 50924	0.25	35-2410 50924	.25	35-2410 50924	.25	35-2410 50924	0.25	35-2410 50924	0.25
Wrench	35-2412 1210	1 8.0	35-2412 1210	1 8.0	35-2412 1210	1 8.0	35-2412 1210	1 8.0	35-2412 1210	1 8.0
Drive Pin	35-2414 1605*	4 10.0	35-2438 1505	4 9.0	-	-	-	-	35-2414 1605*	4 10.0
Drive Pin Washer	35-2416 1506	4 1.0	35-2416 1506	4 1.0	-	-	-	-	35-2416 1506	4 1.0
Holddown Bolt/Stud	35-2318 13501	4 7.0	35-2442 70458	4 5.5	35-2458 1414	4 5.0	35-2466 5230	4 5.0	35-2472 1315	4 5.50
Holddown Retainer	35-2420 50110-8-S	4 0.25	35-2444 72366	4 .25	-	-	-	-	-	-
Lockwasher	35-2422 51110	4 -	-	-	-	-	-	-	-	-
Locking Pin	-	-	-	-	-	-	-	-	35-2474 1316	4 0.25

* 1505 on 20 inch models.

HDP, HDS, 4KPR and 4KRS Roller Kelly Wiper Assemblies and Parts

Cat. #	Ref. #	Description	Wt. Ea.	Qty. Req.	Box
Square Wiper Assemblies					
35-2004	1320-S30	3" Square Kelly Wiper Assembly	12	1	A/R
35-2014	1320-S35	3-1/2" Square Kelly Wiper Assembly	12	1	A/R
35-2024	1320-S42	4-1/4" Square Kelly Wiper Assembly	12	1	A/R
35-2034	1320-S52	5-1/4" Square Kelly Wiper Assembly	12	1	A/R
35-2044	1320-S60	6" Square Kelly Wiper Assembly	12	1	A/R
Hex Wiper Assemblies					
35-2204	1320-H30	3" Hex Kelly Wiper Assembly	12	1	A/R
35-2214	1320-H35	3-1/2" Hex Kelly Wiper Assembly	12	1	A/R
35-2224	1320-H42	4-1/4" Hex Kelly Wiper Assembly	12	1	A/R
35-2234	1320-H50	5" Special Hex Kelly Wiper Assembly	12	1	A/R
35-2244	1320-H52	5-1/4" Hex Kelly Wiper Assembly	12	1	A/R
35-2254	1320-H60	6" Hex Kelly Wiper Assembly	12	1	A/R
Square Wiper Rubber					
35-2005	12100	3" Square x 10" O. D. Kelly Wiper Rubber	5.0	1	A/R
35-2015	12101	3-1/2" Square x 10" O. D. Kelly Wiper Rubber	5.0	1	A/R
35-2025	12102	4-1/4" Square x 10" O. D. Kelly Wiper Rubber	5.0	1	A/R
35-2035	12103	5-1/4" Square x 10" O. D. Kelly Wiper Rubber	5.0	1	A/R
35-2045	12104	6" Square x 10" O. D. Kelly Wiper Rubber	5.0	1	A/R
Hex Wiper Rubber					
35-2205	12107	3" Hex x 10" O. D. Kelly Wiper Rubber	3.5	1	A/R
35-2215	12108	3-1/2" Hex x 10" O. D. Kelly Wiper Rubber	3.6	1	A/R
35-2225	12109	4-1/4" Hex x 10" O. D. Kelly Wiper Rubber	3.0	1	A/R
35-2235	12110	5" Special x 10" O. D. Kelly Wiper Rubber	3.0	1	A/R
35-2245	12111	5-1/4" Hex x 10" O. D. Kelly Wiper Rubber	3.0	1	A/R
35-2255	12112	6" Hex x 10" O. D. Kelly Wiper Rubber	3.0	1	A/R

MD, 4KRVS and 4KBM Roller Kelly Wiper Assemblies and Parts

Cat. #	Ref. #	Description	Wt. Ea.	Qty. Req.	Box
Square Wiper Assemblies					
35-2094	1416-S25	2-1/2" Square Kelly Wiper Assembly	15.4	1	A/R
35-2104	1416-S30	3" Square Kelly Wiper Assembly	15.4	1	A/R
35-2114	1416-S35	3-1/2" Square Kelly Wiper Assembly	15.4	1	A/R
35-2124	1416-S42	4-1/4" Square Kelly Wiper Assembly	15.4	1	A/R
35-2134	1416-S52	5-1/4" Square Kelly Wiper Assembly	15.4	1	A/R
Hex Wiper Assemblies					
35-2294	1416-H30	3" Hex Kelly Wiper Assembly	15.4	1	A/R
35-2304	1416-H35	3-1/2" Hex Kelly Wiper Assembly	15.4	1	A/R
35-2314	1416-H42	4-1/4" Hex Kelly Wiper Assembly	15.4	1	A/R
Square Wiper Rubber					
35-2095	12117	2-1/2" Square x 8-3/8" O. D. Kelly Wiper Rubber	6.0	1	A/R
35-2105	12118	3" Square x 8-3/8" O. D. Kelly Wiper Rubber	6.0	1	A/R
35-2115	12119	3-1/2" Square x 8-3/8" O. D. Kelly Wiper Rubber	6.0	1	A/R
35-2125	12120	4-1/4" Square x 8-3/8" O. D. Kelly Wiper Rubber	6.0	1	A/R
35-2135	12121*	5-1/4" Square x 8-3/8" O. D. Kelly Wiper Rubber	6.0	1	A/R
Hex Wiper Rubber					
35-2295	12125	3" Hex x 8-3/8" O. D. Kelly Wiper Rubber	6.0	1	A/R
35-2305	12126	3-1/2" Hex x 8-3/8" O. D. Kelly Wiper Rubber	6.0	1	A/R
35-2315	12127	4-1/4" Hex x 8-3/8" O. D. Kelly Wiper Rubber	6.0	1	A/R
Kelly Wiper Retainer Plate					
35-2380	1321	HDP, HDS Retainer Plate	9.0	1	A/R
35-2380-1	50008-10-S	HDP, HDS Retainer Plate Bolt	0.5	8	A/R
35-2382	1417	4KRVS and 4KBM Retainer Plate	9.0	1	A/R
35-2382-1	50106-8-SD	4KRVS and 4KBM Retainer Plate Bolt	0.5	8	A/R
35-2384	70491	MDS, MDP Retainer Plate	9.0	1	A/R
35-2384-1	50006-10-C5	MDS, MDP Retainer Plate Bolt	0.5	8	A/R

* Not applicable to MD Kelly Bushing

Rubber Products & Accessories Index Page

Guiberson - Swab Equipment

Page

- Swab Cups1-5
- * Tubing Swab Cups - Rubber3
- * Tubing Swab Cups - Wire Reinforced4
- * Casing Swab Cups5

Guiberson - GW Packers & Cups

- GW Packers & Cups6-7

Guiberson - Accessory Rubbers

- Concentric BOP Rubbers8
- Offset BOP Rubbers8
- Tubing Pipe Wipers8
- JU Stripper Head Rubbers8



Swab Cups

Type NUF



The 'NUF' is a heavy duty, all rubber cup. The 'NUF' combines both long life and maximum capacity lift, even under deep swabbing conditions. Like the HPR, this cup is molded either on a steel or aluminium bushing

Type TUF



The 'TUF' is a flexible cup using a method of attaching the spring steel reinforcing wires to the molded-in valve ring. The 'TUF' is molded from a rubber compound for lifting medium to heavy loads.

Type TA



The 'TA' is a medium duty, all rubber, variable lift cup. The 'TA' is made from a softer rubber which allows for greater flexibility under lighter loads. This Cup is also available with either a steel or aluminum bushing in all popular sizes. The 'TA' can be used on any Guiberson style swab mandrel.

Type J



The 'J' is a very durable heavy duty cup with a long flexibly lip to provide a perfect up stroke seal. The strong steel reinforcing wires are secured by a retaining ring which keeps the wires from snagging, even in the roughest of tubing. Available in many popular sizes, the 'J' cup must be run on Guiberson standard swab mandrel.

Type MV



The 'MV' is a light duty, all rubber cup. The multiple upturned lips pass easily thru tight spots and is especially suited for fluid with a high ratio of suspended sand because the lips will invert to dump an excessive load.

Type GW



The 'GW' cup is molded from abrasion resistant rubber for lifting light loads. The 'GW' seals so well it has become the standard for total fluid removal. The 'GW' is ideal for getting the last drop out of the well and may be run on any Guiberson swab.

Type V



The 'V' is a ring type, single lip, all rubber cup molded onto a steel bushing. This cup is ideal for lifting fluids heavy with sand and or light load swabbing. The flexible 'V' quickly and automatically dumps excess loads. The number of 'V' cups may be varied to meet the swabbing conditions and can be run on any Guiberson style swab.

Type H



The 'H' Oil Saver Rubber's specially compounded of oil resistant rubber and is designed to give positive seal with long-wearing qualities.

Type UF

The 'UF' is an all-purpose cup containing strong, flexible spring steel reinforcing wires and a molded in-valve ring. The "UF" is made from a very flexible rubber for lighter loads.

TUBING SWAB CUPS - ALL RUBBER

TUBING DATA				TYPE NUF			TYPE TA			TYPE MV			TYPE V		SWAB CUP ID (IN.)
O.D. Nominal	Weight (LB/FT)	Tubing (IN.)	Min. JT. ID (IN.)	Rig Tool Part # Reference # (OEM)			Rig Tool Part # Reference # (OEM)			Rig Tool Part # Reference # (OEM)			Rig Tool Part # Reference # (OEM)		
				STEEL BSHG	ALUM. BSHG	OD (IN.)	STEEL BSHG	ALUM. BSHG	OD (IN.)	STEEL BSHG	ALUM. BSHG	OD (IN.)	STEEL BSHG	OD (IN.)	
1.315 (1")	1.70-1.80	1.049	0.970	-	-	-	-	75-0402A 54510	1.000	-	-	-	-	-	0.430
1.660" (1-1/4")	2.30-2.40	1.380	1.300	-	-	-	-	75-0403A 54511	1.350	-	-	-	-	-	0.569
1.900" (1-1/2")	2.75-2.90	1.610	1.530	-	-	-	-	75-0404A 53689	1.600	-	-	-	75-0604S 87422	1.605 ID=0.915	0.759
								75-0404A1 59890*	1.560						
2.000"	3.40	1.670	-	-	-	-	-	75-0405A 53690	1.660	-	-	-	-	-	0.759
2.063" (1-3/4")	3.25-3.40	1.751	1.700	-	-	-	-	75-0406A 53691	1.710	-	75-0506A 57842	1.720	-	-	0.759
		4.50	1.613	1.550	-	-	-	75-0405A 53690	1.660						
2-3/8" (2")	4.60-4.70	1.995	1.945	75-0207S 88682	75-0207A 91066	1.935	75-0407S 61024	75-0407A 53409	1.990	75-0507S 87791	75-0507A 57468	1.984	75-0607S 57835	1.992	1.084
							75-0407S1 63612*	75-0407A1 54508*	1.950						
	5.10-5.30	1.939	1.890	75-0207S 88682	75-0207A 91066	1.935	-	-	-	-	-	-	-	-	
	5.80-5.95 5.96-6.20 6.30-6.65	1.853 1.867 1.815	1.850 1.795 1.815	75-0207S1 91145	-	1.785	-	-	-	-	-	-	-	-	
2-7/8" (2-1/2")	6.40-6.50	2.441	2.371	75-0208S 89784	75-0208A 91067	2.370	75-0408S 61025	75-0408A 53494	2.431	75-0508S 87792	75-0508A 57469	2.430	75-0608S 57836	2.431	1.375
							75-0408S1 62930*	75-0408A1 54507*	2.385						
	7.70-7.90	2.323	2.265	75-0208S1 91070	-	2.245	-	-	-	-	-	-	-	-	
	8.60-8.70	2.259	2.200	75-0208S2 89783	-	2.180	-	-	-	-	-	-	-	-	
	8.90	2.243	2.181	-	-	-	-	-	-	-	-	-	-	-	
	9.35-9.50	2.195	2.089	-	-	-	-	75-0408A2 55235	2.111	-	-	-	-	-	
9.80-10.40	2.151	2.130	-	-	-	-	-	-	-	-	-	-	-	1.084	
11.54-11.65	1.995	-	-	75-0207S 88682	75-0207A 91066	1.935	75-0407S 61024	75-0407A 53409	1.990	75-0507S 87791	75-0507A 57468	1.992	75-0607S 57835	1.992	
3-1/2" (3")	9.20-9.50	2.992	2.920	-	-	-	75-0413S 89689	75-0413A 53692	2.940	75-0513S 89690	75-0513A 57839	2.974	75-0613S 57642	2.985	1.375
	10.20-10.30	2.922	2.870	-	-	-	-	-	-	-	-	-	-		

* Undersize Cup - For faster fall and plastic lined or internal upset tubing.

TUBING SWAB CUPS - WIRE REINFORCED

TUBING DATA				TYPE TUF			TYPE UF			TYPE GW		I.D.
O.D. NOM (IN.)	WEIGHT (LB/FT)	TUBING I.D. (IN.)	MIN. JT. I.D. (IN.)	R.T. PART # REF. #	CUP O.D. (IN.)	CUP I.D. (IN.)	R.T. PART # REF. #	CUP O.D. (IN.)	CUP I.D. (IN.)	R.T. PART # REF. #	CUP O.D. (IN.)	J & GW CUP (IN.)
1.315 (1")	1.70-1.80	1.049	0.970	-	-	-	75-0902 38831	0.970	0.437	-	-	-
1.660" (1-1/4")	2.30-2.40	1.380	1.300	-	-	-	75-0903 38869	1.300	0.578	-	-	-
1.900" (1-1/2")	2.75-2.90	1.610	1.530	-	-	-	75-0904 29641	1.520	0.688	-	-	-
2.000"	3.40	1.670	-	-	-	-	75-0905 45307	1.650		-	-	-
2.063" (1-3/4")	3.25-3.40	1.751	1.700	-	-	-	75-0906 31594 75-0905 45307*	1.694 1.650	0.688	-	-	-
	4.50	1.613	1.550	-	-	-	75-0904 29641	1.520		-	-	-
2-3/8" (2")	4.60-4.70	1.995	1.945	75-0807 68333	1.910	1.078	-	-	-	75-1107 10716	2.000	1.940
	5.10-5.30	1.939	1.890				-	-	-	-	-	-
2-7/8" (2-1/2")	6.40-6.50	2.441	2.371	75-0808 69845	2.360	1.350	-	-	-	75-1108 10047	2.490	1.344
	8.60-8.70	2.259	2.200	-	-	-	-	-	-	-	-	1.094
	8.90	2.243	2.245	-	-	-	-	-	-	-	-	
	9.35-9.50	2.195	2.130	-	-	-	-	-	-	-	-	
	9.80-10.40	2.151	2.151	-	-	-	-	-	-	-	-	
	11.54-11.65	1.995	-	75-0807 68333	1.910	1.078	-	-	-	75-1107 10716	2.000	
3-1/2" (3")	9.20-9.50	2.992	2.920	-	-	-	-	-	-	75-1113 14960	3.020	1.344
	10.20-10.30	2.992	2.870	-	-	-	-	-	-	-	-	
	12.80-13.30	2.764	-	-	-	-	-	-	-	75-11131 14082	2.770	
	12.70-12.95	2.750	2.687	-	-	-	-	-	-			
	14.90-15.50	2.602	-	-	-	-	-	-	-	-	-	
4"	9.50	3.548	-	-	-	-	-	-	-	-	-	1.938
	10.80-11.95	3.476	3.395	-	-	-	-	-	-	75-1117 14036	3.526	

* Undersize Cup - For faster fall and plastic lined or internal upset tubing.

CASING Swab Cups

CASING DATA			TYPE V			TYPE J	TYPE JS	J & JS		TYPE GW							
O.D. NOM	WEIGHT (LB/FT)	I.D. (IN.)	R.T. PART # REF. #	CUP O.D. (IN.)	CUP I.D. (IN.)	R.T. PART # REF. #	R.T. PART # REF. #	CUP O.D. (IN.)	CUP I.D. (IN.)	R.T. PART # REF. #	CUP O.D. (IN.)	CUP I.D. (IN.)					
4-1/2"	9.50	4.090	75-0621	4.062	2.420	75-1321	75-1421	4.060	4.060	75-1121	4.180	2.400					
	11.60	4.000	57467										45597	61495	19841		
4-1/2" D.P.	13.75	3.958	75-0621	-	-	75-1321	75-1421			75-1121	4.180		75-11211	4.020	2.410		
	16.60	3.826	S	-	-	-	-			19840							
4-3/4"	16.00	4.082	75-0621	4.062	2.420	75-1321	75-1421			75-1121	4.180		19841	4.180	2.410		
5"	13.00	4.494	S	-	-	-	-			75-1125	4.630		19843	4.630	2.410		
	15.00	4.408	S	-	-	-	-			75-11251	4.490	19842	4.490	2.410			
5-1/2"	13.00	5.044	75-0629	4.970	2.420	75-1329	75-1429			5.010	5.010	75-1129	5.140	2.910			
	14.00	5.012	88884*	4.970	2.920										45829	61496	
	15.00	4.974	75-06291	4.970	2.420	-	-								75-11291	5.020	19844
	15.50	4.950	75-0629	-	-	75-13291	-	4.838	5.020						19844	5.020	2.900
	17.00	4.892	S	-	-	-	-	-	-						-	-	-
5-3/4"	14.00	5.290	S	-	-	-	-	-	2.435	75-1131	5.440	2.910					
	17.00	5.190	S	-	-	-	-	-	75-1131	19847	5.440						
6"	22.50	4.990	75-0629	4.970	2.420	75-1331	75-1429	5.010	5.010	75-1129	5.140		2.910				
	14.00	5.552	S	-	-	-	-	-	-	75-1133	5.670	19848					
6-5/8"	20.00	6.049	S	-	-	-	-	-	-	75-1135	6.240	3.531					
	22.00	5.989	S	-	-	-	-	-	-	75-1135	19850		6.240				
7"	24.00	5.921	S	-	-	-	-	-	-	75-11351	6.030		19849				
	28.00	5.791	S	-	-	-	-	-	-	75-11351	6.030	19849					
7"	17.00	6.538	75-0638	6.475	3.545	75-1338	-	6.520	2.435	75-1138	6.665	3.531					
	20.00	6.456				45831	-	6.520		19853	6.665						
	22.00	6.398	57471	-	-	75-13381	-	6.320		75-11381	6.550		19852				
	23.00	6.366	-	-	-	52385	-	-		-	-		-				
	24.00	6.336	-	-	-	-	-	-		-	-		-				
	26.00	6.276	S	-	-	-	-	-		-	75-1135		6.240	19850			
29.00	6.184	-	-	-	-	-	-	-	75-11351	6.030	19849						
7-5/8"	32.00	6.094	-	-	-	-	-	-	-	75-1140	7.150	19855					
	35.00	6.004	-	-	-	-	-	-	-	75-11401	6.990	19854					
7-5/8"	26.40	6.969	-	-	-	-	-	-	-	-	-	-					
	29.70	6.875	-	-	-	-	-	-	-	-	-	-					
7-5/8"	33.70	6.765	-	-	-	-	-	-	-	-	-	-					
	39.00	6.625	-	-	-	-	-	-	-	-	-	-					

S Indicates that this size cup is available by special order
 * 88884 is an alternate swab cup which is made to run in 5-1/2" on a 4-1/2" mandrel
 ** 93480 is a heavy duty alternate to 57467

GW Packers and Cups

O.D. (IN.)	CASING PPF	OBSOLETE STD P/N	GW-SS STD SERVICE N-75	GWD-HD HVY DUTY N-85	GWD-ST STEAM EPDM N-85	GW-SP SEAL POSITIVE HNBR N-75	OBSOLETE SPEC P/N	GW SWAB N-75
			R.T. PART # REF. #	R.T. PART # REF. #	R.T. PART # REF. #	R.T. PART # REF. #		R.T. PART # REF. #
2-3/8"	4.6		75-1107 10716					75-1107 10716
2-7/8"	6.4	12993	75-1108 10047		75-1708 87307			75-1108 10047
	8.8							
3-1/8"	3-1/8" ID		75-1510 16370			75-1810 16370		
3-1/2"	9.2 - 10.2		75-1113 14960		75-1713 87310	75-1813 16146		75-1113 14960
	Large ID Kobe		75-1513 16146					
			75-15131 61943					
	12.95 - 13.3		75-11131 14082		75-17131 87311			75-11131 14082
4"	9.5-11.6	14034	75-1117 14036		75-1717 87312			75-1117 14036
4-1/2"	9.5 - 12.6	13486	75-1521 30509	75-1621 54864	75-1721 87313			75-1121 19841
	13.5 - 18.9		75-15211 10430	75-16211 54430	75-17211 87314			75-11211 19840
5"	13.5 - 15.0	13764	75-1525 25389	75-1625 54865	75-1725 87315			75-1125 19843
	18.0 - 21.0	13489	75-15251 17831	75-16251 54866				75-11251 19842
5-1/2"	13.0 - 15.0	13241 22624 93989	75-1529 22625	75-1629 54753	75-1729 87318	75-1829 30848	13654	75-1129 19846
	15.5 - 17.0	15237 22626						
	17.0 - 23.0	13402 19710 57460	75-15291 19711	75-16291 54761	75-17291 87316	75-18291 30846	13657	75-11291 19844
5-3/4"	14.0 - 17.0		75-1531 14714		75-1731 87335			75-1131 19847
6"	14.0 - 18.0		75-1533 14721		75-1733 87336		16178	75-1131 19847
	20.0		75-15331 14714		75-17331 87337			75-1133 19848

HNBR (Chemical Resistant)
EPDM (Temperature Steam or Water)

GW Packers and Cups

O.D. (IN.)	CASING PPF	OBSOLETE STD P/N	GW-SS STD SERVICE N-75	GWD-HD HVY DUTY N-85	GWD-ST STEAM EPDM N-85	GW-SP SEAL POSITIVE HNBR N-75	OBSOLETE SPEC P/N	GW SWAB N-75
			R.T. PART # REF. #	R.T. PART # REF. #	R.T. PART # REF. #	R.T. PART # REF. #		R.T. PART # REF. #
6-5/8"	20.0 - 24.0	14723	75-1535 19389	75-1635 54872	75-1735 87319			75-1135 19850
	28.0 - 32.0	14144	75-15351 19277	75-16351 54870	75-17351 87320	75-1835 30851	14962	75-11351 19849
	32.0					75-1835-1 30850	15490	
7"	17.0 - 20.0	13427	75-1538 17819	75-1638 54819	75-1738 87322	75-1838 30584	14648	75-1138 19853
	22.0 - 24.0	14232 17461 54796	75-15381 17462	75-16381 54797	75-17381 87323	75-1838-1 30853	14650	75-11381 19852
	26.0 - 30.0	13385 17356 54810			75-17382 87321	75-1838-2 30852	14649	75-11382 19851
7-5/8"	26.4 - 29.7	14178	75-1540 19391	75-1640 54826	75-1740 87338			75-1140 19855
	33.7 - 39.0	16410 21293	75-15401 23051	75-16401 54825	75-17401 87339			75-11401 19854
8"	26.0				75-1743 87324	75-1843 93421		
8-5/8"	28.0 - 36.0		75-1545 16111		75-1745 87326	75-1845 16110		
	36.0 - 40.0	16113 87325 16112	75-15451 16115		75-17451 87327	75-18451 16114		
	40.0 - 49.0							
9"	40.0 - 45.0		75-1548 15941		75-1748 87328	75-1848 15942		
9-5/8"	36.0 - 43.5		75-1550 10354	75-1650 54354	75-1750 87329	75-1850 14970		
	47.0 - 53.5		75-15501 33850	75-16501 54850	75-17501 87330			
10-3/4"	32.5 - 43.5		75-1556 13197	75-1656 54034	75-1756 87331			75-1156 19034
	55.5 - 65.7		75-15561 13198	75-16561 54198	75-17561 87332			
11-3/4"	38.0 - 60.0		75-1561 14246	75-1661 54296	75-1761 87333			
	60.0 - 65.0		75-15611 14247	75-16611 54297	75-17611 87335			
13-3/8"	48.0 - 72.0		75-1569 16298	75-1669 54298	75-1769 87334			

**HNBR (Chemical Resistant)
EPDM (Temperature Steam or Water)**

Guiberson - BOP Rubbers

Cat. #	Ref. #	Description	Qty. Req.	Box
Concentric BOP Rubbers				
75-8000	18368	Concentric BOP Rubber Blank	2	2
75-8002	80898	Concentric BOP Rubber, 1" (1.315")	2	2
75-8003	28325	Concentric BOP Rubber, 1-1/4" (1.660")	2	2
75-8004	32740	Concentric BOP Rubber, 1-1/2" (1.900")	2	2
75-8005	37514	Concentric BOP Rubber, 2"	2	2
75-8006	34804	Concentric BOP Rubber, 2-1/16" (2.063")	2	2
75-8007	61744	Concentric BOP Rubber, 2-3/8"	2	2
75-8008	61745	Concentric BOP Rubber, 2-7/8"	2	2
75-8013	61746	Concentric BOP Rubber, 3-1/2"	2	2
75-8017	24075	Concentric BOP Rubber, 4"	2	2
75-8021	18367	Concentric BOP Rubber, 4-1/2"	2	2
75-8025	22220**	Concentric BOP Rubber, 5" (Type B-1 Only)	2	2
75-8029	69951**	Concentric BOP Rubber, 5-1/2" (Type B-1 Only)	2	2
75-8038	69950**	Concentric BOP Rubber, 7" (Type B-1 Only)	2	2
Offset BOP Rubbers				
75-8102	37990	Offset BOP Rubber, 1" (1.315")	2	2
75-8103	34889	Offset BOP Rubber, 1-1/4" (1.660")	2	2
75-8104	32644	Offset BOP Rubber, 1-1/2" (1.900")	2	2
75-8105	54767	Offset BOP Rubber, 2"	2	2
75-8106	34813	Offset BOP Rubber, 2-1/16" (2.063")	2	2
75-8107	29760	Offset BOP Rubber, 2-3/8"	2	2
Tubing Pipe Wipers				
75-8204	89600	Tubing Pipe Wiper, 1-1/2" (1.900")	1	A/R
75-8207	89601	Tubing Pipe Wiper, 2-3/8"	1	A/R
75-8208	89602	Tubing Pipe Wiper, 2-7/8"	1	A/R
75-8213	89602-001	Tubing Pipe Wiper, 3-1/2"	1	A/R
JU Stripper Head Rubber				
75-8300	24077	JU Tubing Rubber, 1.050" to 1.660"	1	A/R
75-8305	9444	JU Tubing Rubber, 1.900" to 2-3/8"	1	A/R
75-8310	9447	JU Tubing Rubber, 2-7/8"	1	A/R
75-8315	15184	JU Drill Pipe Rubber, 2-7/8"	1	A/R
75-8320	16562	JU Tubing Rubber, 3-1/2"	1	A/R